

FAST TRACK

2+1 GN STRAIGHT LOAD SERIES



2 HORSE TRAILERS

STANDARD FEATURES

- 22' Floor; 7' Wide; 7'6" Tall. Stalls 39-1/2" W x 84" L
- Gooseneck w/ 92" Attic, Adjustable Ball Style GN Hitch
- Improved All Box Tube Aluminum Chassis
- One Piece, .040 Aluminum Roof w/ Heavy Duty Radius Roof Extrusion
- Extruded Aluminum Decking
- .040 Pre-Painted Exterior Side Sheets, Full Length Running Boards
- Tandem 7K Braked, Dexter Torsion Ride Axles
- Silver Mods., 235/80R16 - 8 Lug Wheels
- Newly Designed Straight Load Dividers w/ 2"x3" Heavy-Wall Upright, includes Divider Pads and Padded Head and Butt Bars
- Tack Room Features - 44" Tack, 20"x72" Pass-Thru Door to Horse Area, Rubber Mats, LED Dome Light, Pull-out Saddle Racks (Stores Under Manger), Bridle Hooks, Brush Tray, Wall Mounted Blanket Bar & (2) 18"x24" Sliding Windows w/ Screens in GN
- Spring Loaded Side Ramp (Rubber Lined) w/ Wrap Around Tail Curtain w/ Sliding Window & Bars (53"x19") w/ Aluminum Hardware w/ Huck Bolts & Keyed Locking Hasps
- Full-Height Stud Door (Per-Stall)
- Large Sliding Windows w/ Screen and Bars (53"x19"), Per Stall (3 Total for Base Trailer. One in Each Rear Stall and One on Side Ramp Curtain)
- 1/2" Rubber Mats; Heavy Duty Wall Liner in Horse Area
- (2) Inside & (1) Outside Tie-Ring, Per Horse
- (3) LED Dome Lights w/ Toggle Switch
- Double Action Pop-up Vent Per-Stall

- 32"x78" Tack Storage Door w/ 18"x24" Sliding Window
- 32"x78" Escape Door w/ 18"x24" Sliding Window and Bars
- 32"x25" Premium Square Drop Down Feed Windows w/ Integrated FaceBar (1-per stall)
- Spring Loaded Rear Ramp (Rubber Lined) w/ Wrap Around Tail Curtains w/ Sliding Window & Bars (18"x24") w/ Sliding Windows & Bars, Aluminum Hardware w/ Huck Bolts & Keyed Locking Hasps
- 5-Year Limited Warranty

ADDITIONAL OPTIONS

- Upgrade to 8' Wide
- Additional 1' Length in Horse Area
- Additional 1' Length in Tack Area
- Stainless Steel Nose Wrap - Mirror Finish
- Upgrade to 16" 235 Aluminum (Radial; From 16" 235 Silver Mod Radial)
- Upgrade to 16" G-Rated Silver Mod Wheels (Radial, From 16" Silver Mod Radial)
- Add 6" to Box Height (Horse Models); PBF
- 53"x19" Sliding Window w/ Screen & Bars (Side Ramp Curtain)
- Lower Partition on Divider (w/ Mill Finish)
- .030 Wall Liner w/o Insulation (Tack Area-GN)
- .030 Ceiling Liner w/o Insulation (Tack Area-GN)
- .030 Wall Liner w/o Insulation Above HD Liner (Horse Area) PLF
- .030 Ceiling Liner w/o Insulation (Horse Area; PLF)
- Upgrade to Rubber Wall Liner (48") in Horse or Stock Area w/ .063 Aluminum Backer (PLF per Wall & Rear Door, From HD Wall Liner)
- Rubber Flooring (Replaces Extruded Aluminum & Rubber Mats) - (Horse Models; PLF)
- Carpeted Floor in Tack Area (Set)
- Carpeted Attic Floor and Drop Wall (Set)
- Floor-Level Spare Tire Mount
- Spare 16" Silver Mod Wheel w/ 235/80R16 Tire
- Extruded Side Panels (Up To Window Height; PLF)
- Two-Tone Color Package - No Anodized Divider

SCHEMATICS

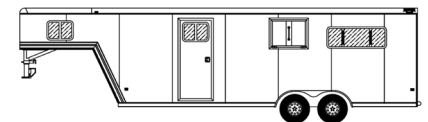
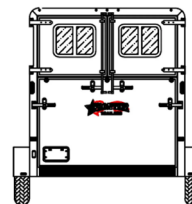
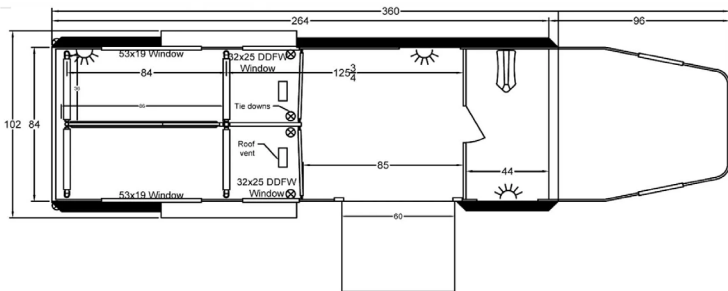

COLOR OPTIONS

